

GROUND FLOOR
APPROX. FLOOR AREA
373.93 SQ.FT.
(34.74 SQ.M.)

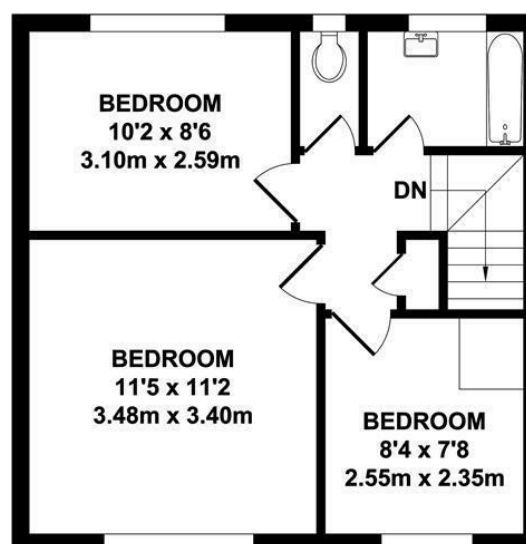

FIRST FLOOR
APPROX. FLOOR AREA
373.93 SQ.FT.
(34.74 SQ.M.)

TOTAL APPROX. FLOOR AREA 747.87 SQ.FT. (69.48 SQ.M.)

Whilst every attempt has been made to ensure the accuracy of the floor plan contained here, measurements of doors, windows, rooms and any other items are approximate and no responsibility is taken for any error, omission or mis-statement. This plan is for illustrative purposes only and should be used as such by any prospective purchaser. The services, systems and appliances shown have not been tested and no guarantee as to their operability or efficiency can be given.

Zome Media ©2023



01732 522 822
info@khp.me



Mid Kent Shopping Centre
Allington ME16 OPU
£1,250 PCM

Tenure:

Council tax band: B



Available for rent is this 3 bed, split level apartment situated in a convenient location in the heart of Allington, a popular suburb of Maidstone.

Comprising a generous size sitting room, newly fitted kitchen, 3 bedrooms and family bathroom (with separate WC). There is also an outside space to enjoy.

Allington has 2 off the most respected Primary schools in KCC and offers easy access to the secondary (including Grammar) schools in the area. Barming station is a short drive, which offers trains to London Victoria. The M20 is a short drive which offers access to London or further out to Kent and beyond.

Viewing is strictly by appointment, call now to arrange your viewing.

Holding deposit - £288
Deposit £1440
Council tax band - B
EPC rating - D

- 3 bed split level apartment
- Convenient location
- Newly fitted kitchen
- New bathroom
- Private outside space
- Living room
- Holding deposit - £288
- Deposit - £1440
- EPC rating - D
- Council tax tax band - B

